

Albion Architectural Concrete

MAKING THE BUILT ENVIRONMENT BETTER

Albion Technical Data - Heads

Fig 1. One Piece or Multi-stone Head

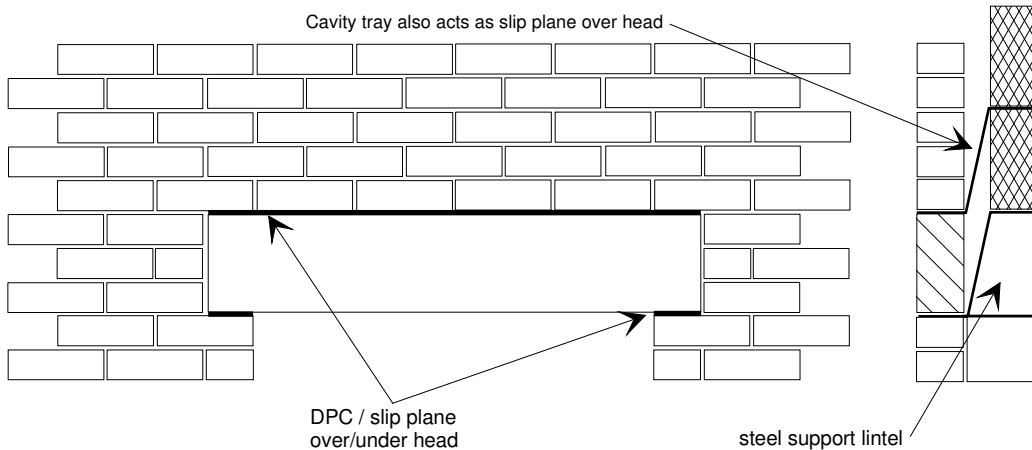

N.B. All cast stone heads should be installed in accordance with BS 5628-3.

Heads are non-load bearing and appropriate structural support **must** be provided to carry the imposed loads from above. One piece and multi-stone heads can be supported from below on a box-type steel lintel (see above diagram).

Self Supporting Heads

One piece heads can be self-supporting. They will require a steel lintel, longer than the cast stone head, to transfer the imposed loads from above into the adjacent masonry. A slip plane will be required at the end of the cast stone head as well as a soft joint between the top of the head and the steel support lintel.

DPCs and Cavity Trays

It is important to provide a waterproof barrier over all heads that will channel and discharge water to the outside face of the masonry. A cavity tray should be inserted over the cast stone head, this will act as a DPC and also as a slip plane.

Fig 2. Self-supporting or One Piece Head

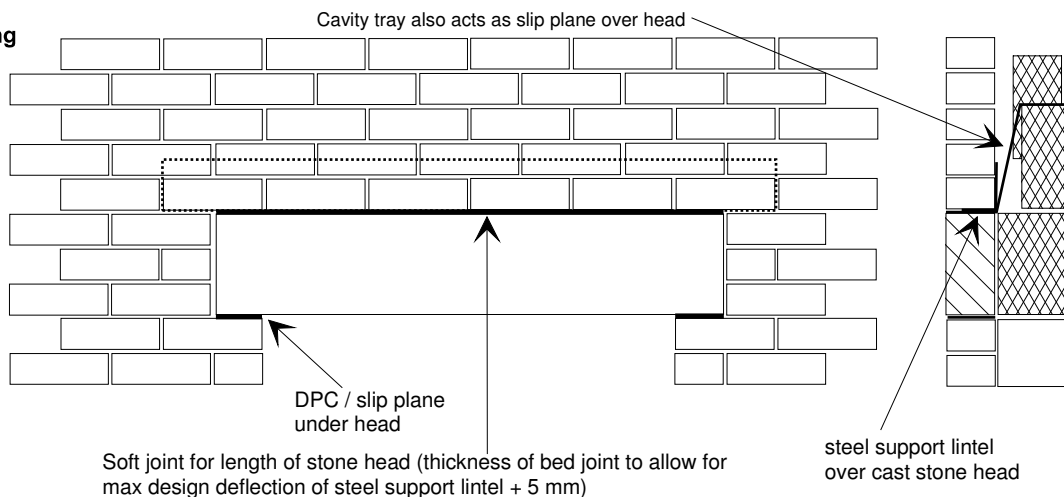

The above information is for guidance only. It is provided in good faith and is to the best of our knowledge accurate, but is offered without liability or guarantee. If you are in any doubt, expert advice should be sought.

Albion Architectural Concrete
 Newbrook Works
 Pound Lane
 Upper Beeding
 West Sussex BN44 3JD
 Tel: 01903-815262 Fax: 01903-815619
 web: www.albionart.co.uk info@albionart.co.uk